

Einbauanleitung



DE | Video – Montage
EN | Video – Installation
FR | Vidéo – Installation
IT | Video – Installazione
PL | Wideo – Montaż

EN Installation manual
FR Instructions de montage
NL Montagehandleiding
IT Guida per il montaggio
ES Instrucciones de montaje
PT Instruções de instalação
PL Instrukcja montażu

CZ Montážní návod
SK Návod na montáž
SI Navodila za vgradnji
RU Руководство по монтажу
GR Οδηγίες τοποθέτησης
EE Paigaldusjuhend
LV Uzstādīšanas instrukcija

LT Montavimo instrukcija
RO Manual de montare
HU Beépítési útmutató
HR Upute za ugradnju
BG Монтажна инструкция

Rx

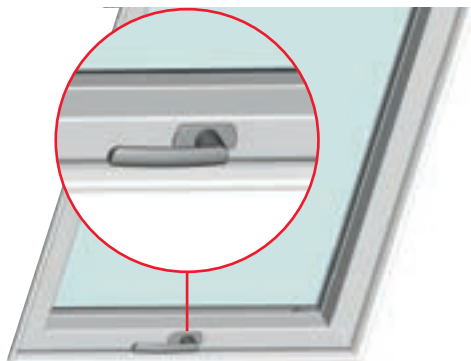

Classic



Q4 E_ EF SF

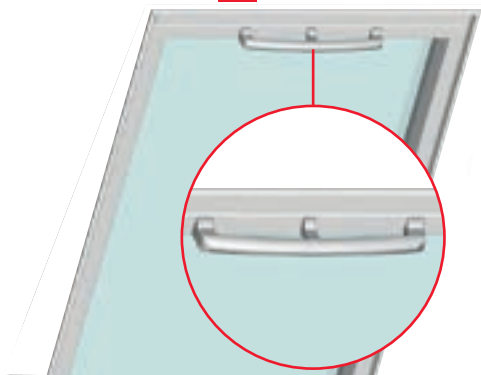



Rx4

R4R7, R3DA, R5RW, R4 E_ EF, R6R8, R6 E_ EF,
R8DA, R8SA, i8



Classic16

61/62/73/84



Q418

Q4 E_ EF SF



.....32



Rx

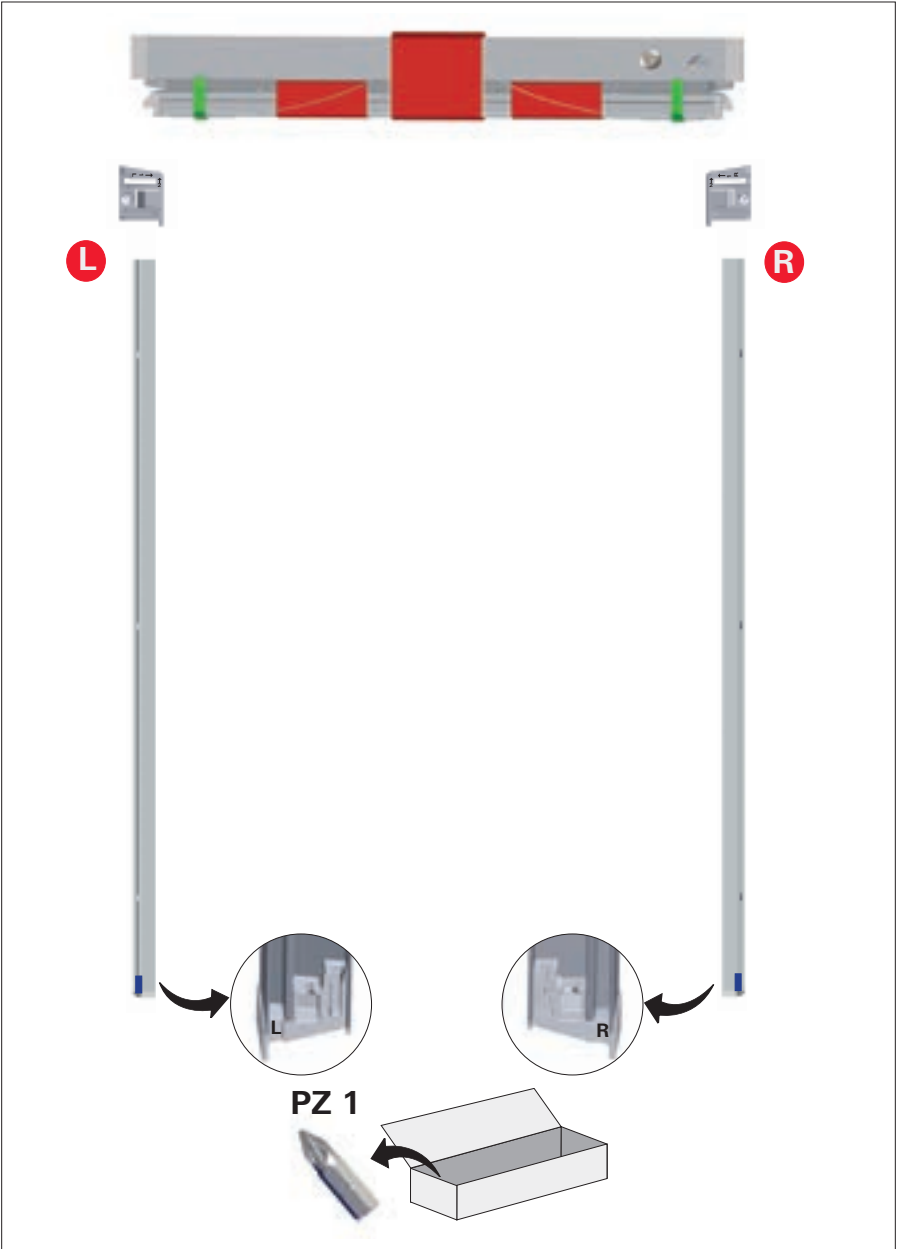

1

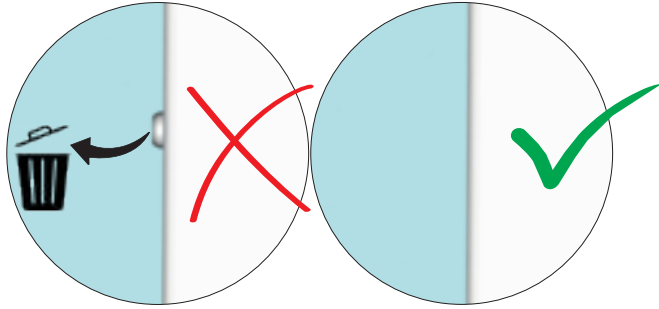



Rx

2

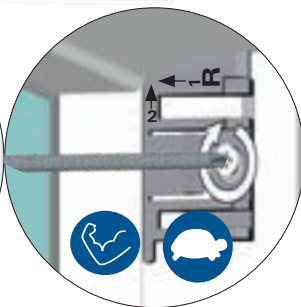
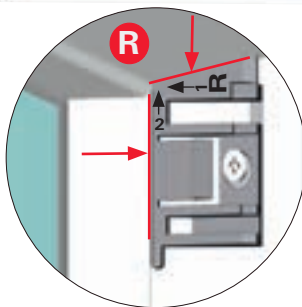
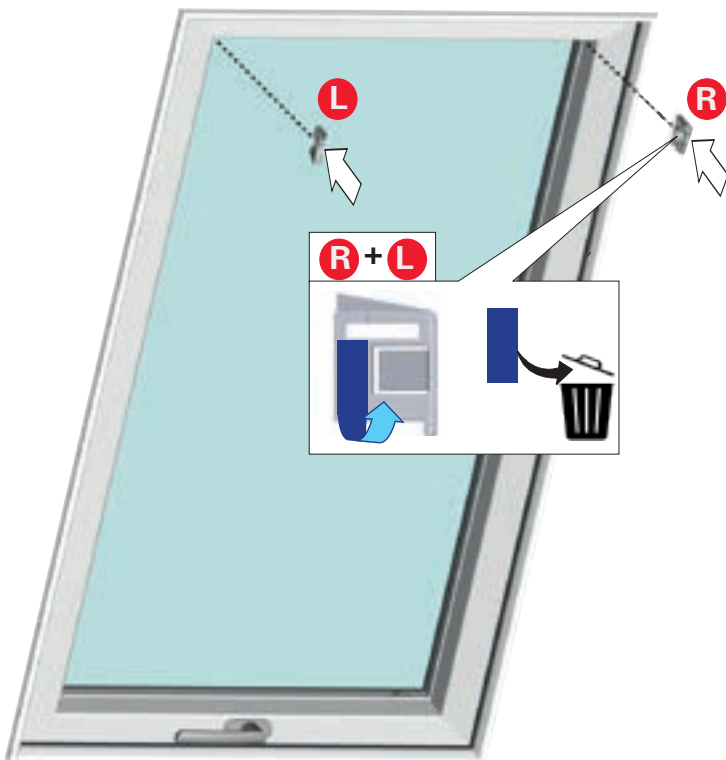
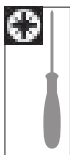
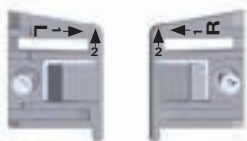

3

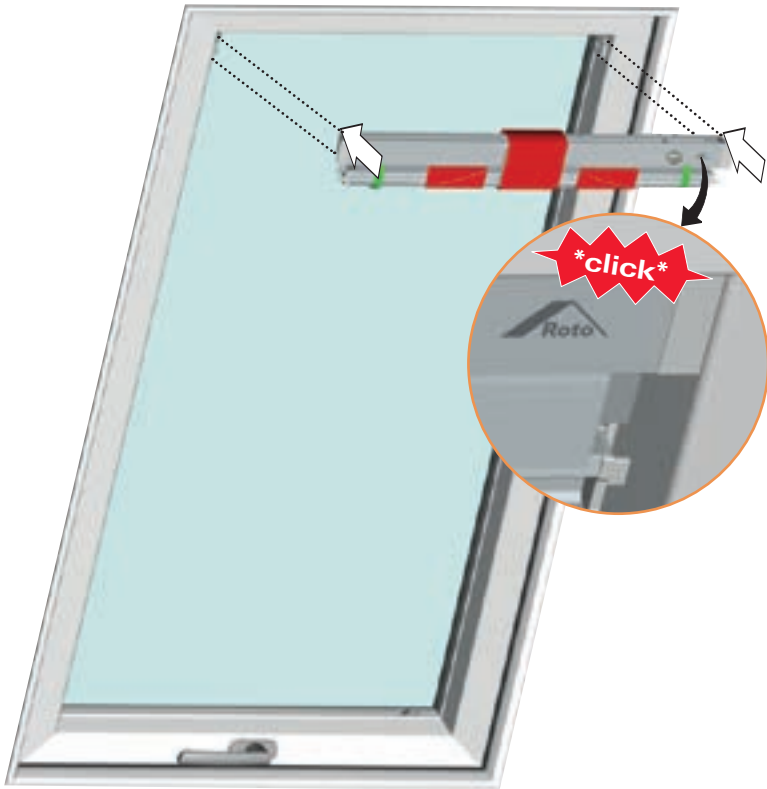



Rx

4

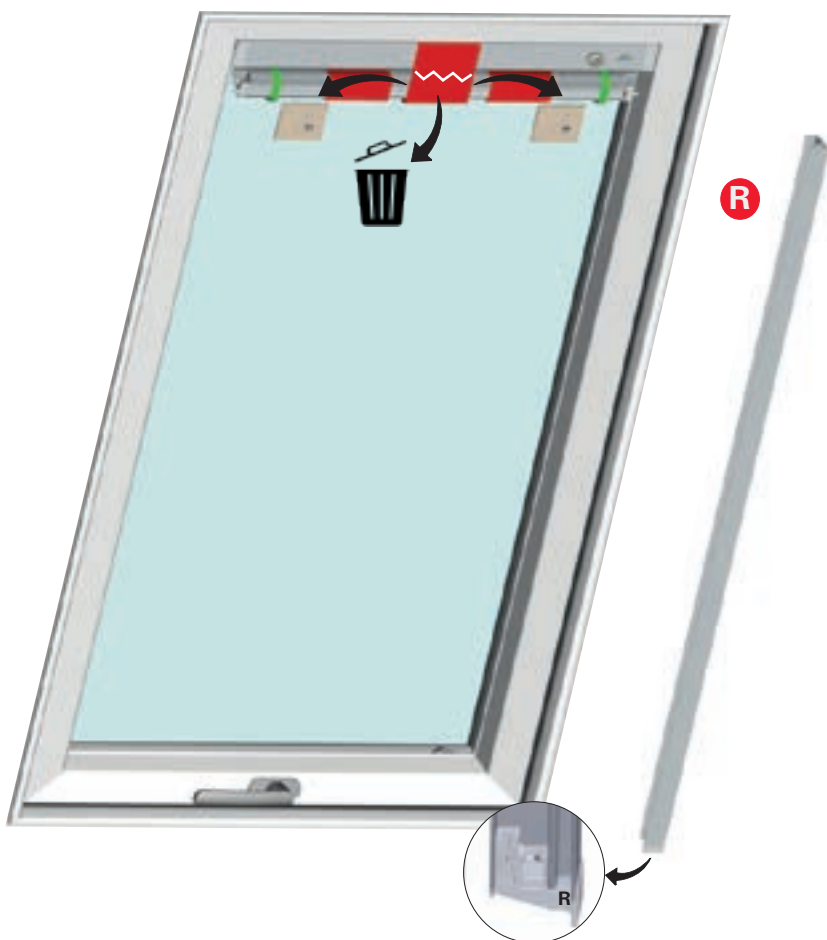

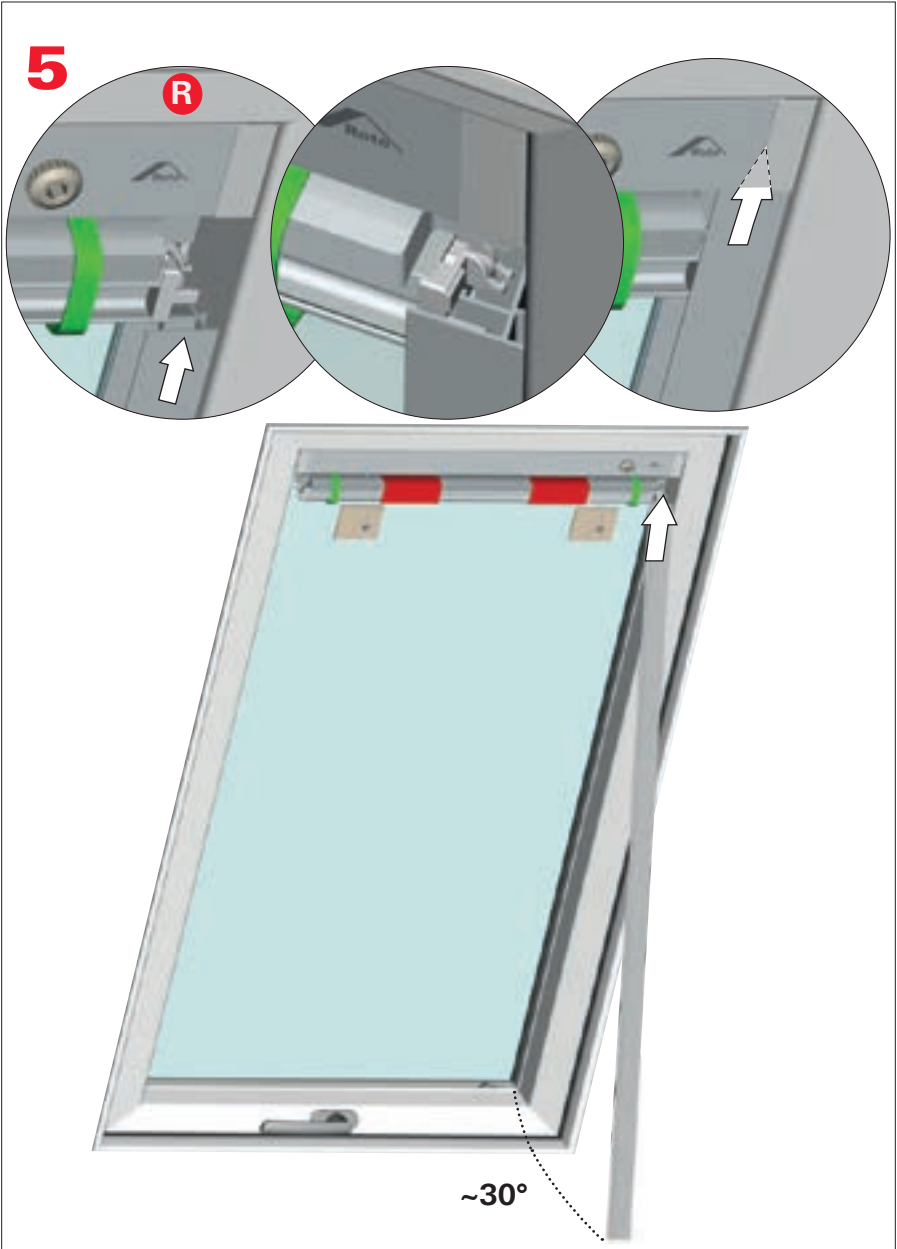



Rx

6

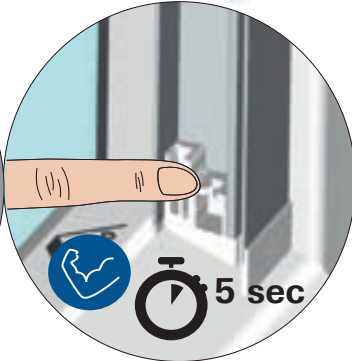
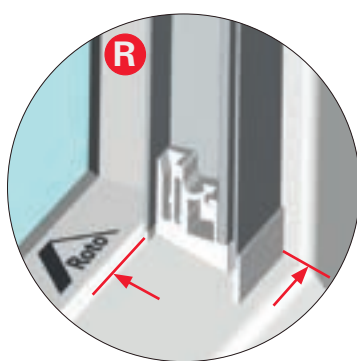

7

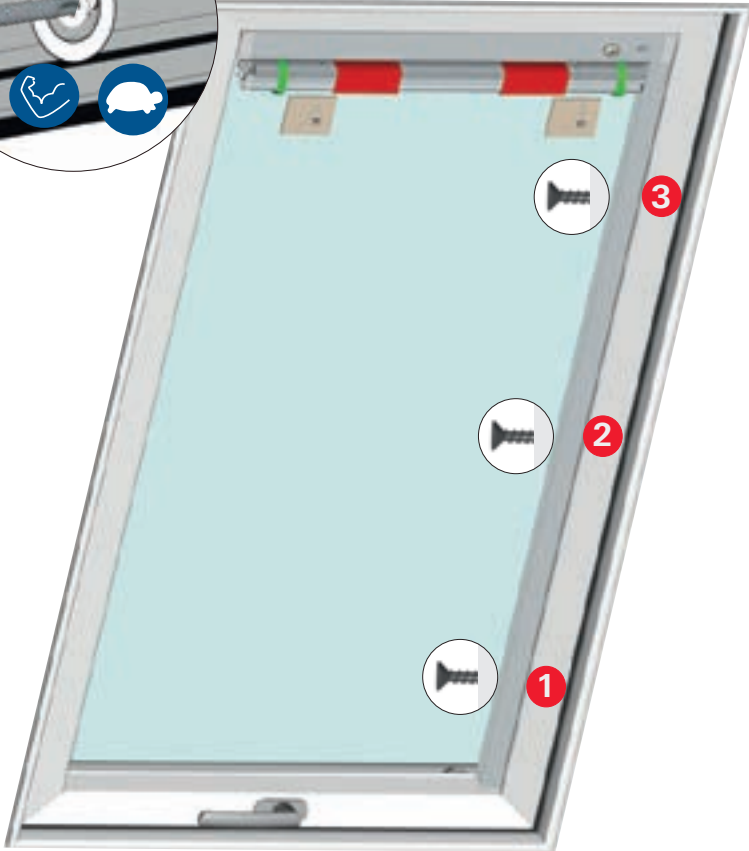



Rx

8

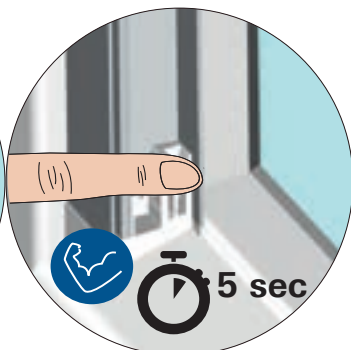
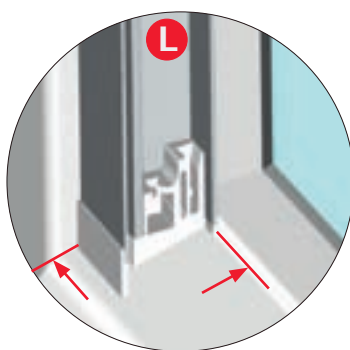

9

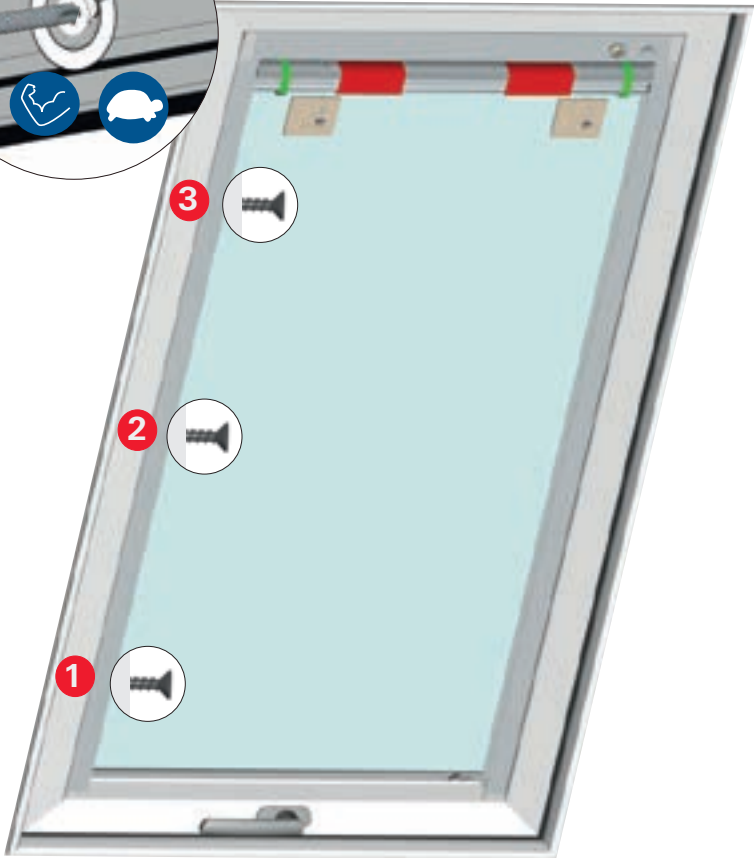
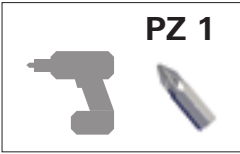
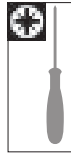



Rx

10

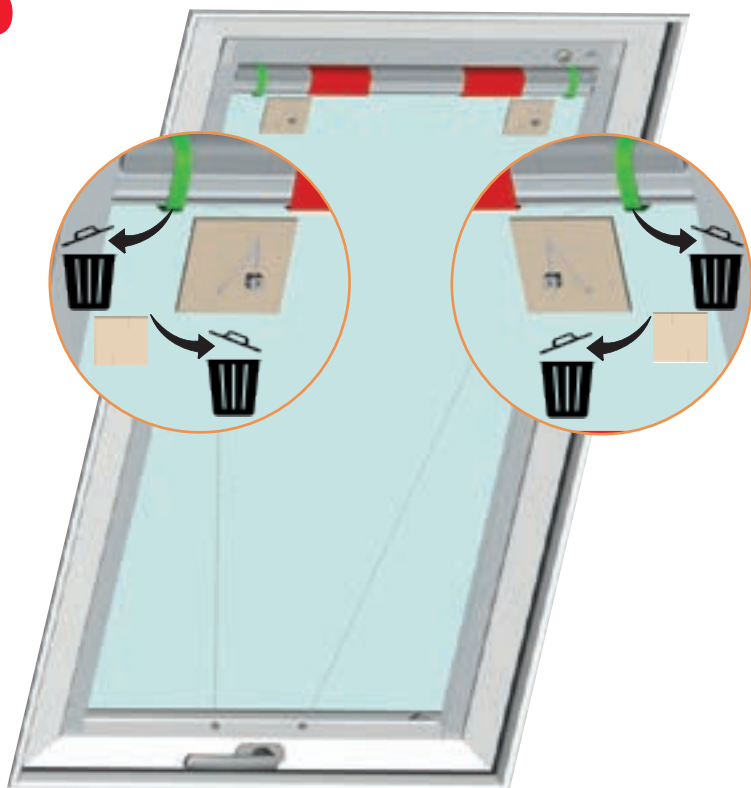

11

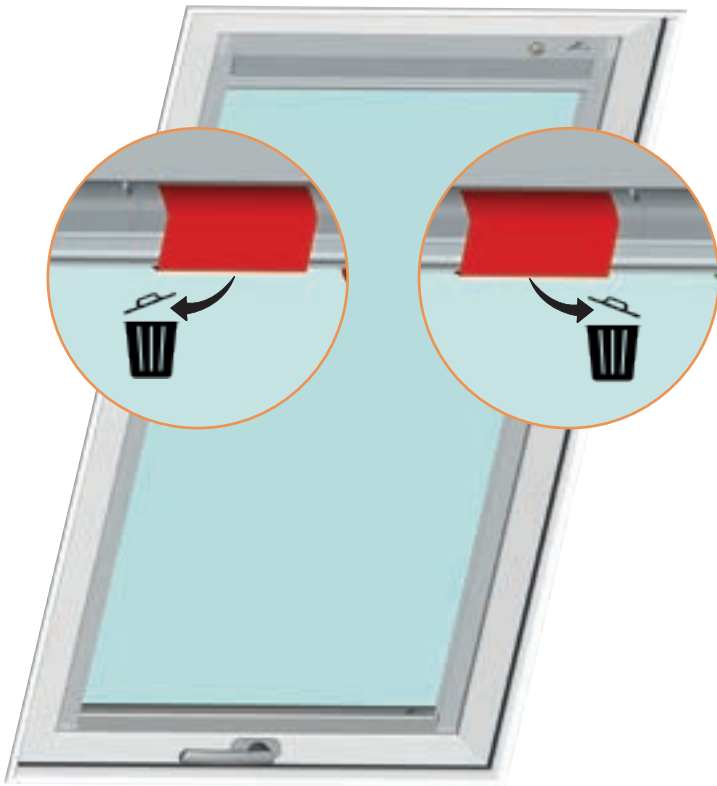



Classic

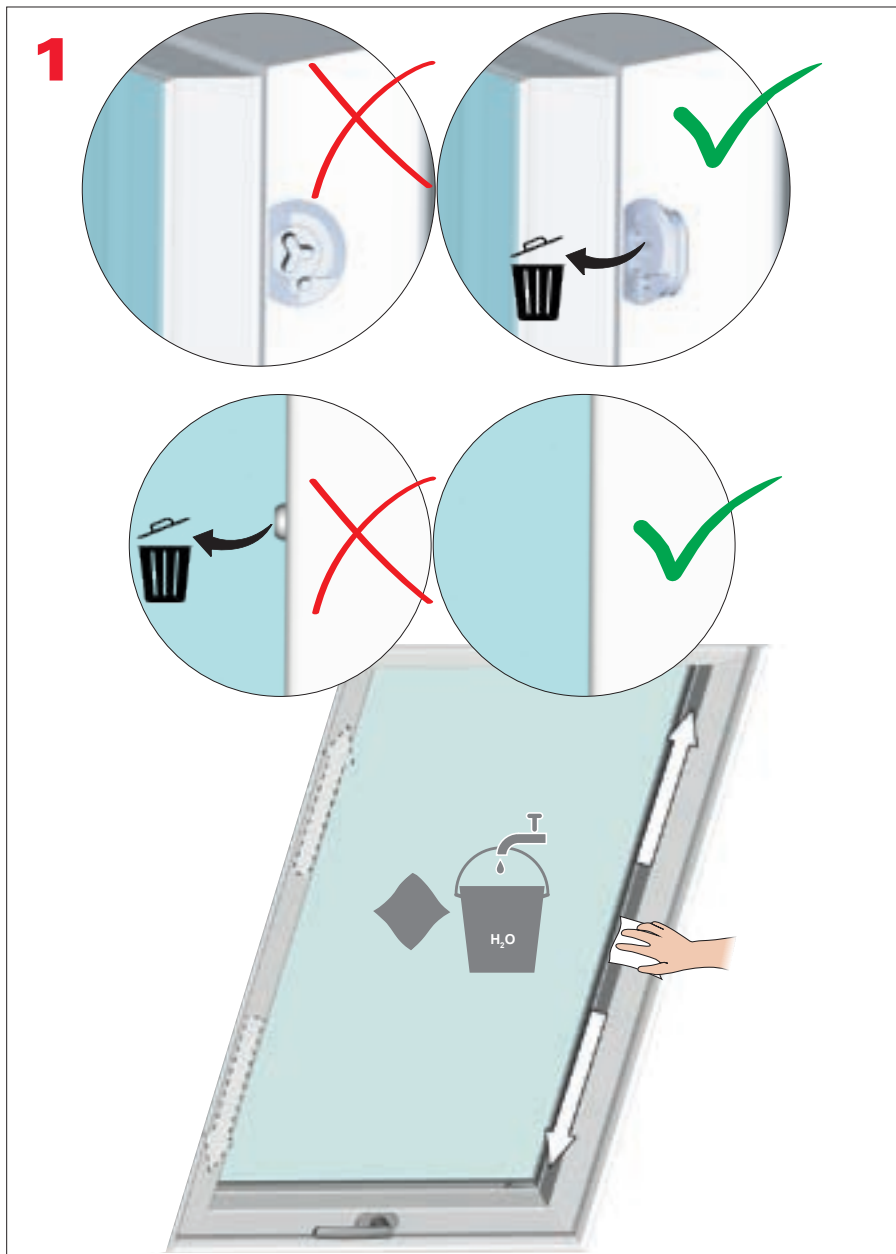

2

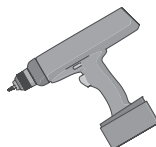
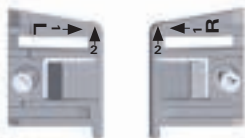

Ø 2mm

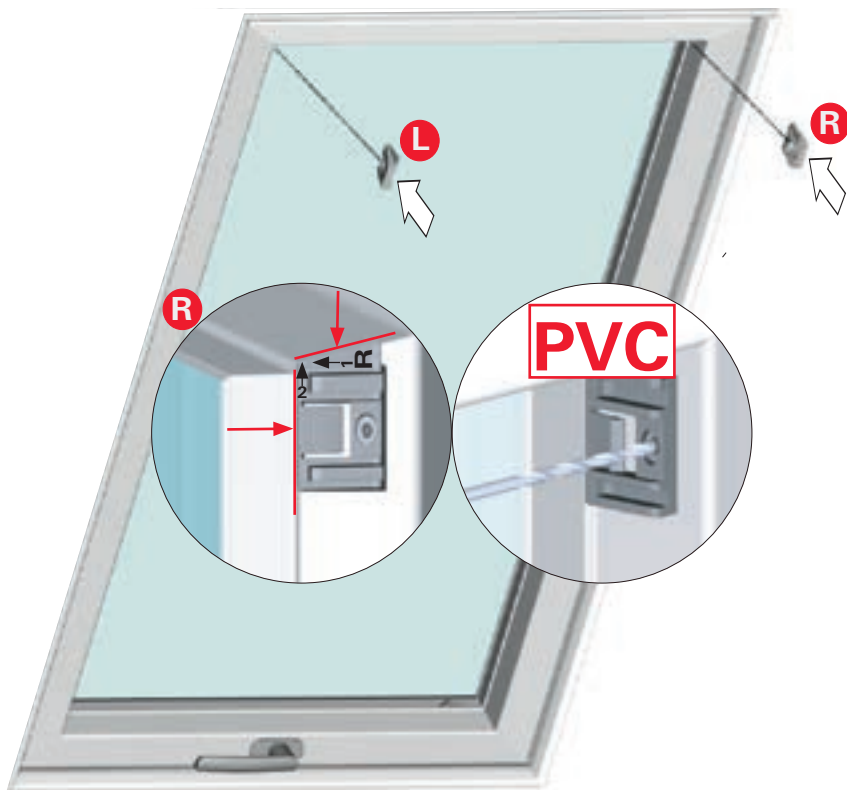



Q4

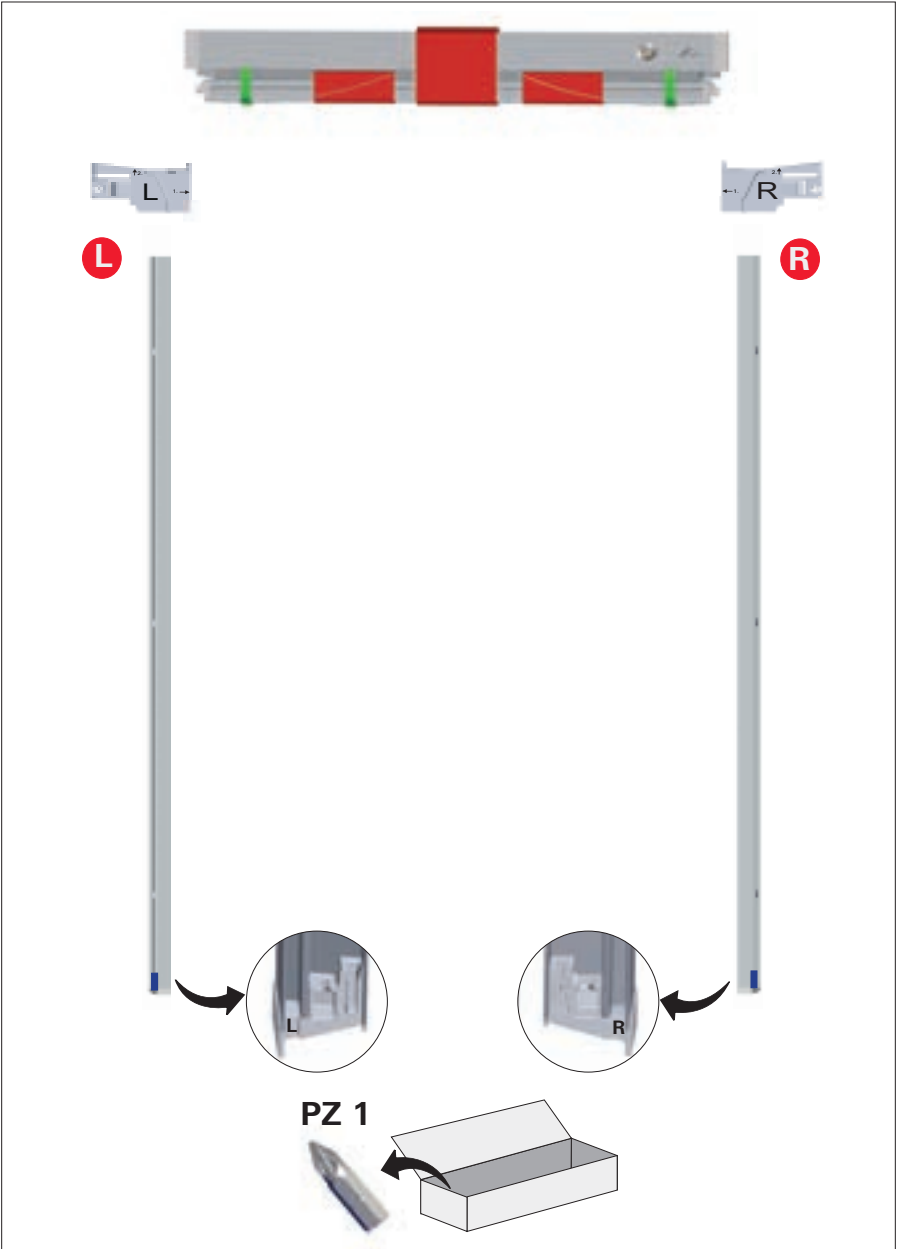

1

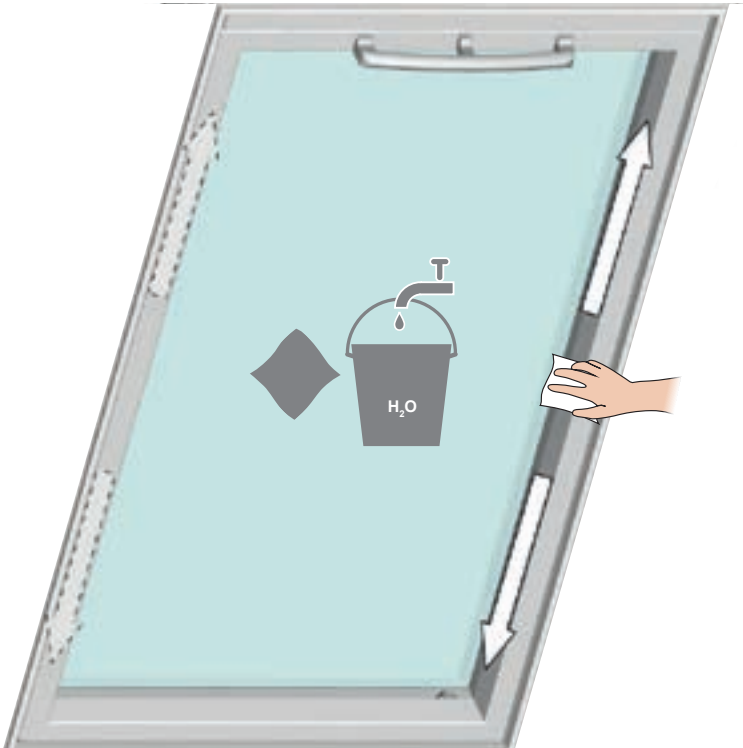
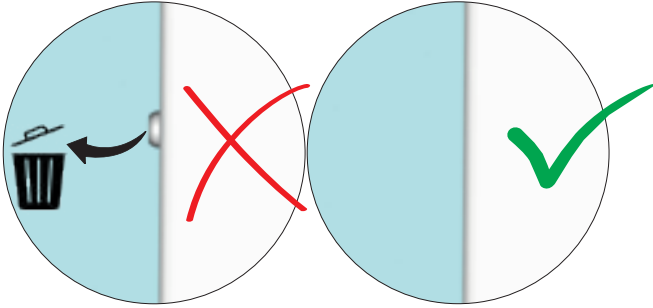



Q4

2

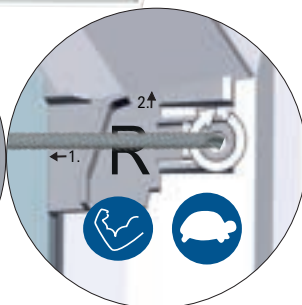
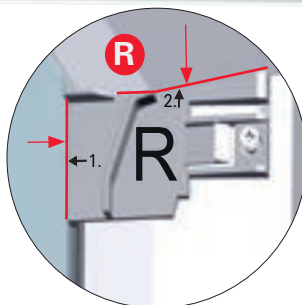
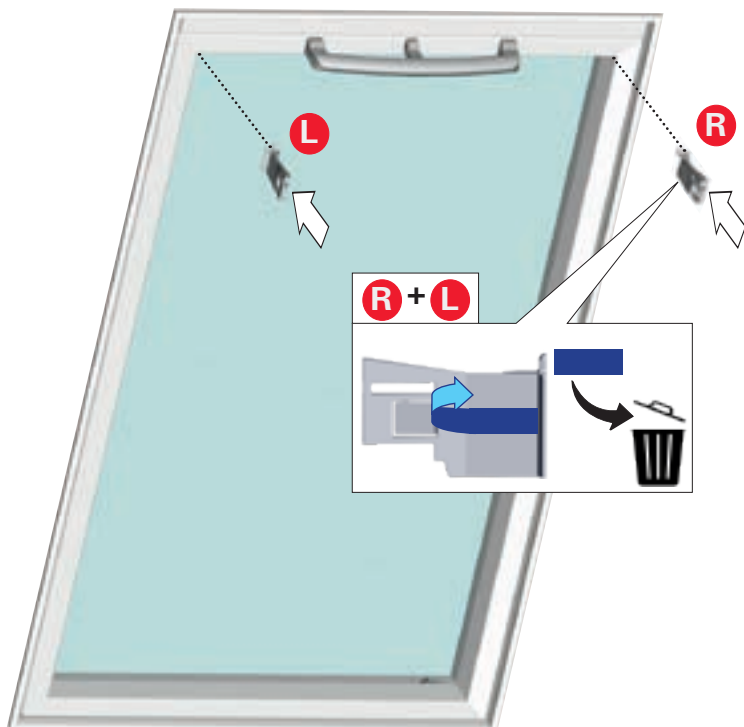
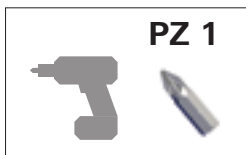
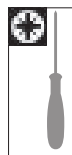
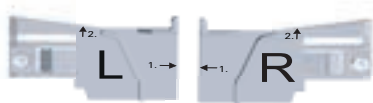

3

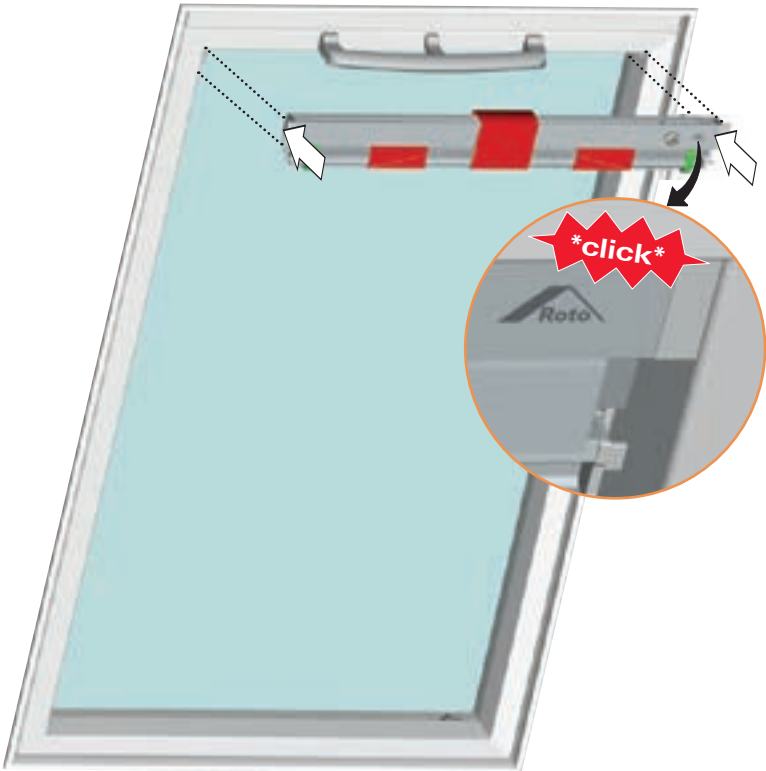



Q4

4

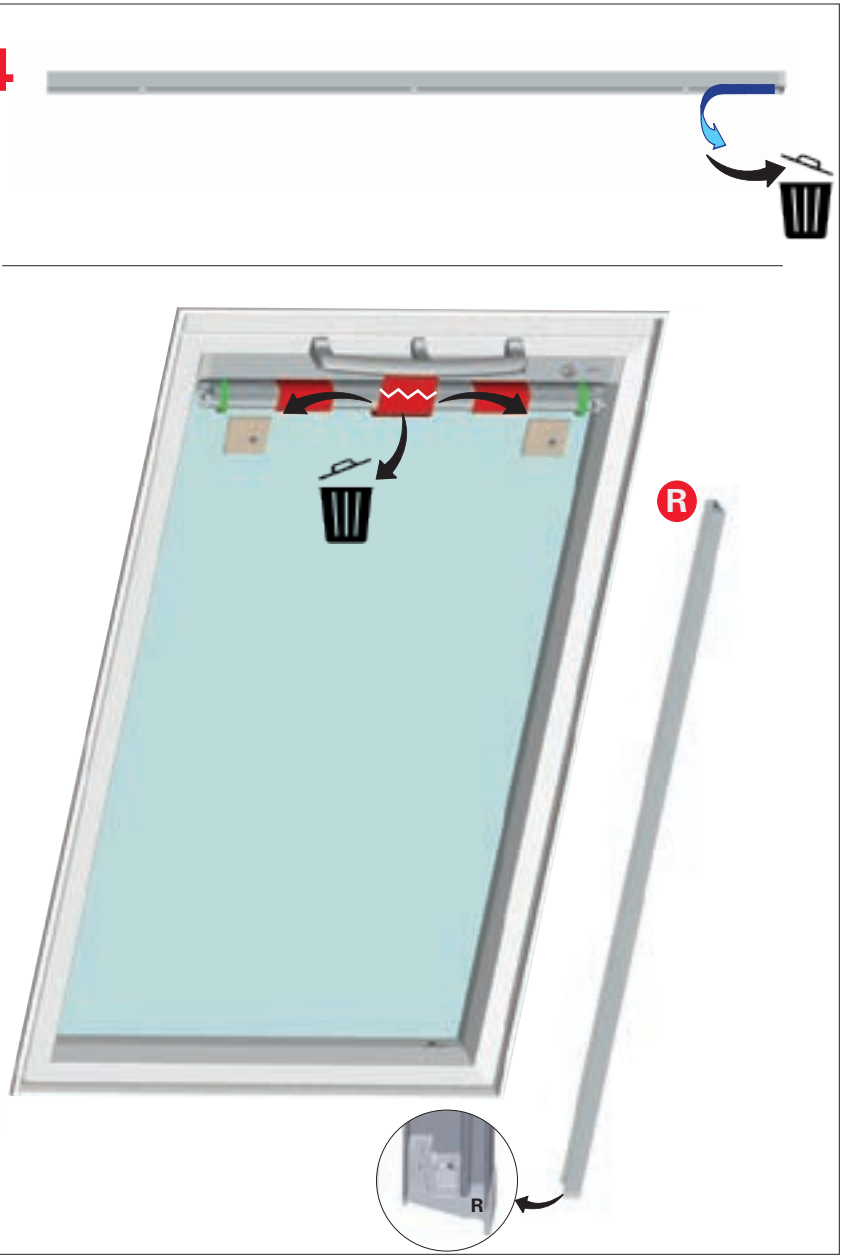

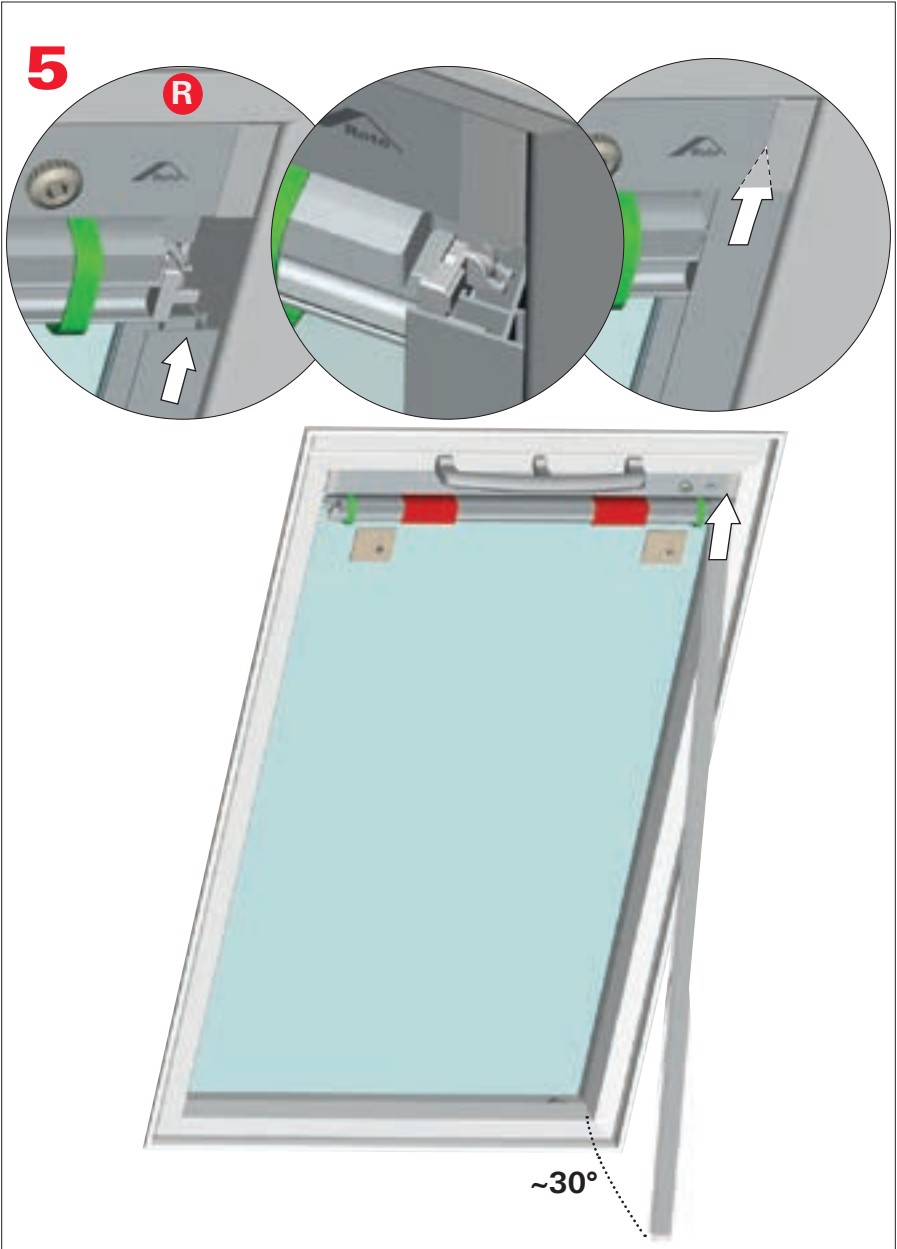



Q4

6

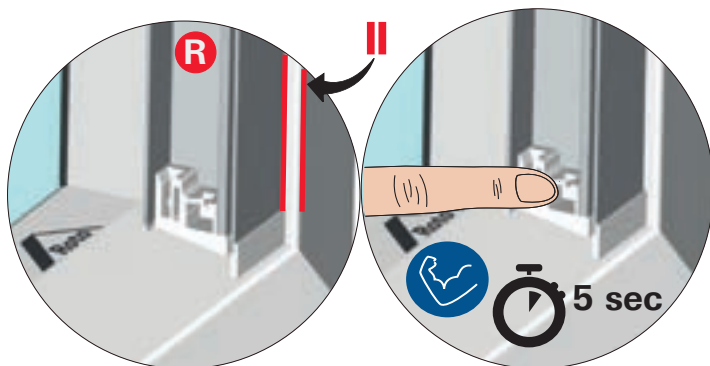
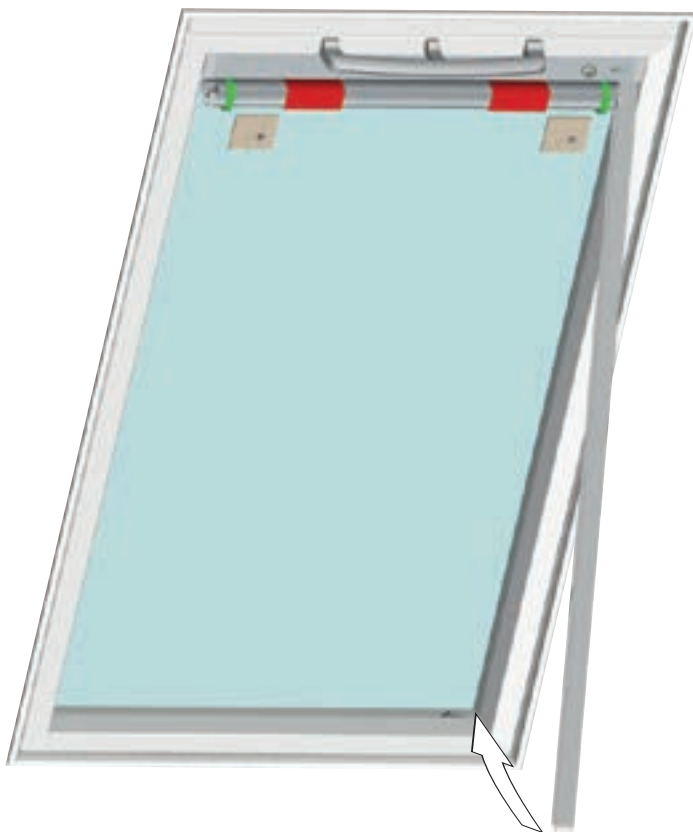

7

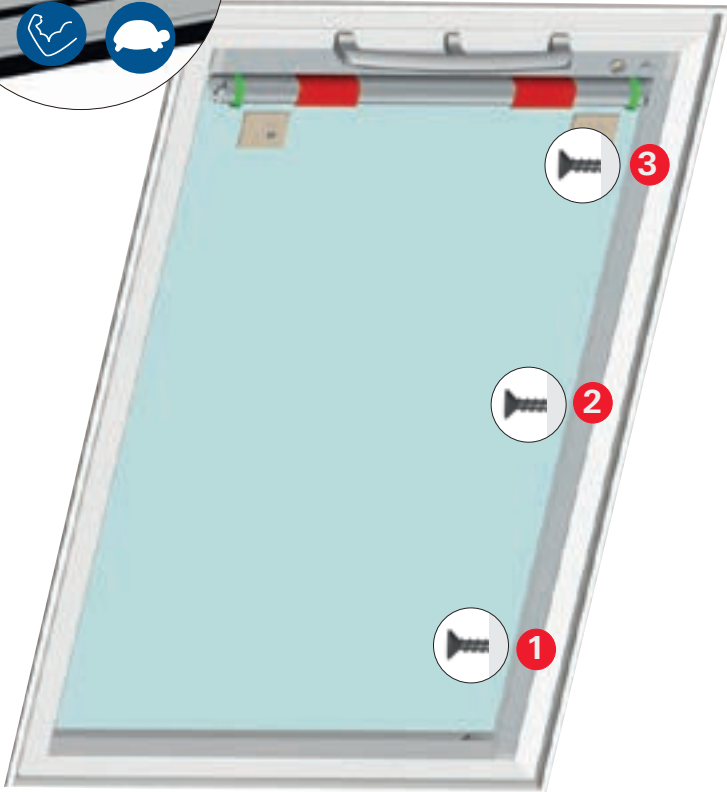



Q4

8

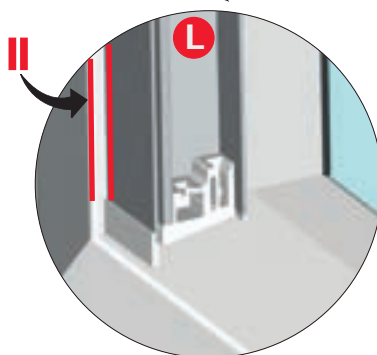
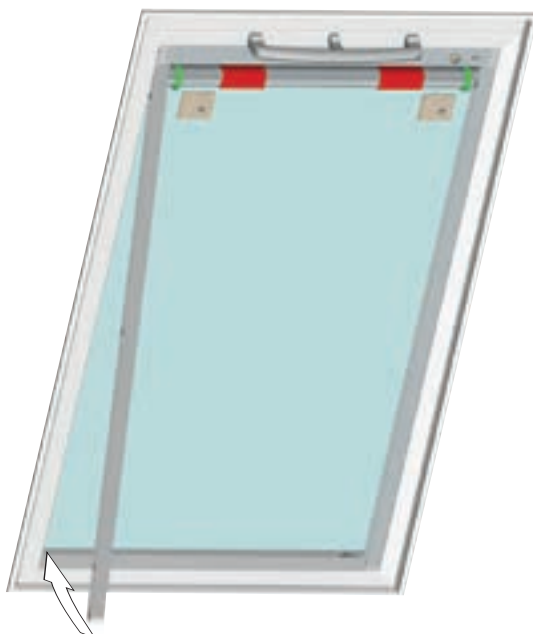

9

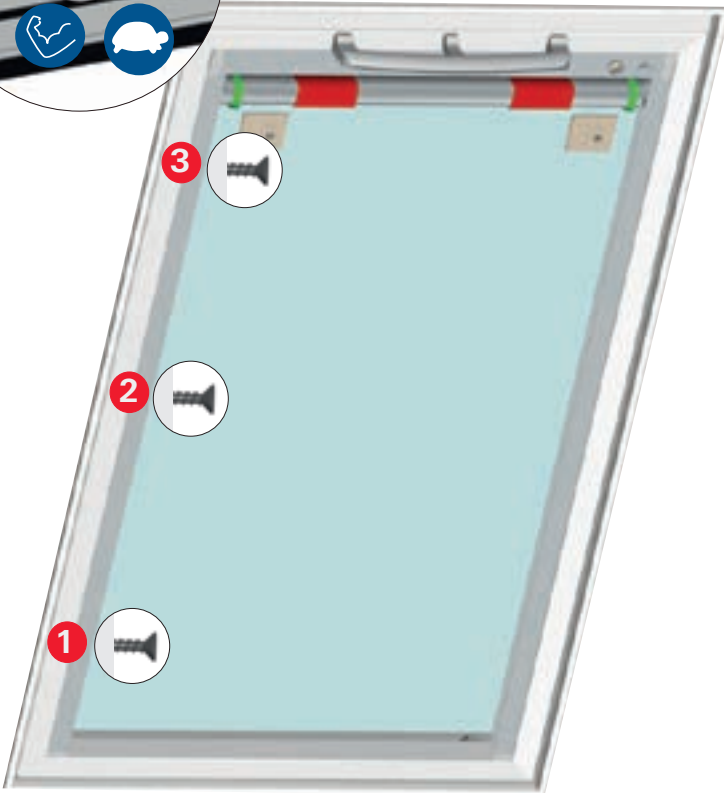
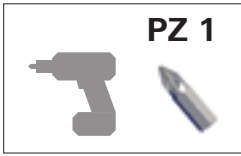
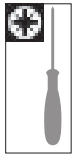



Q4

10

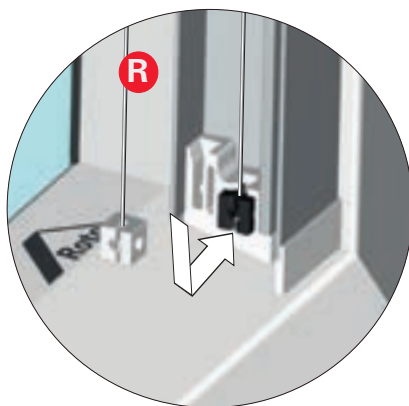
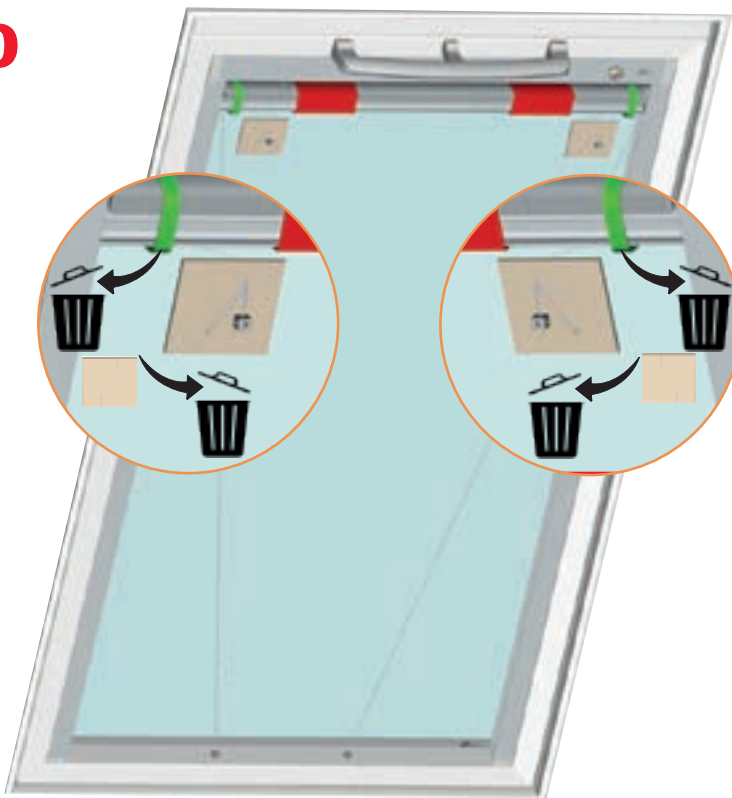

11

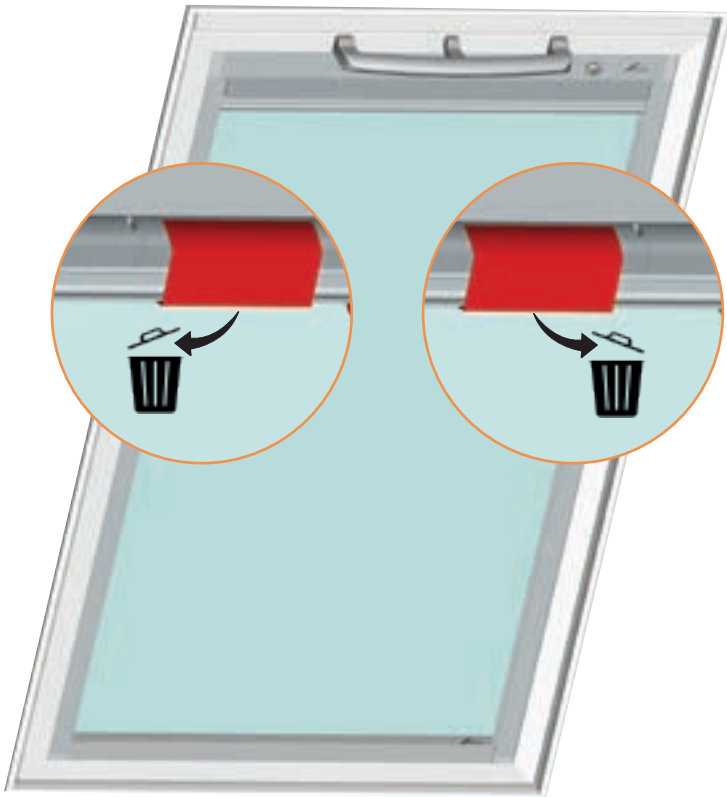



Rx/Q4/Classic

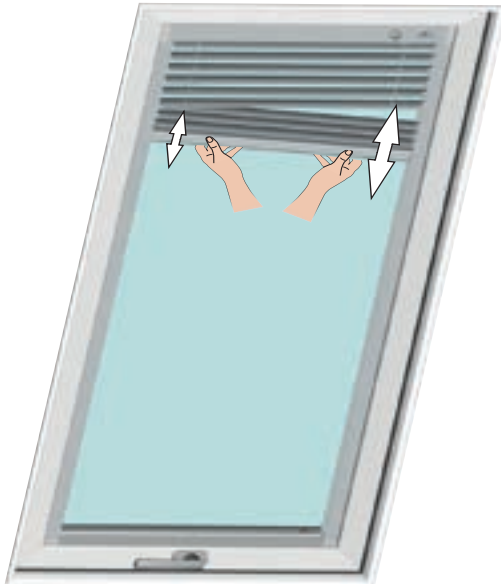
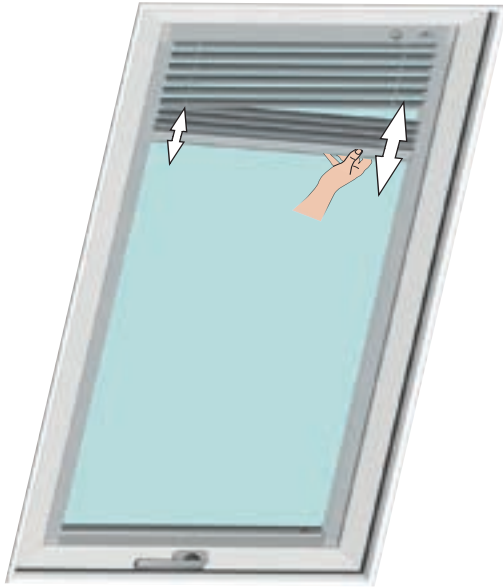

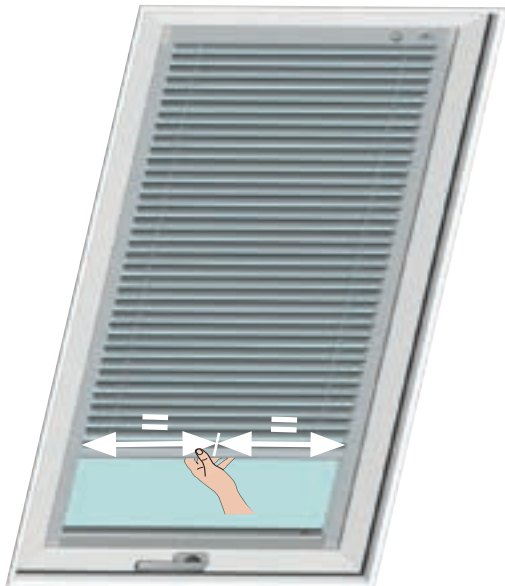
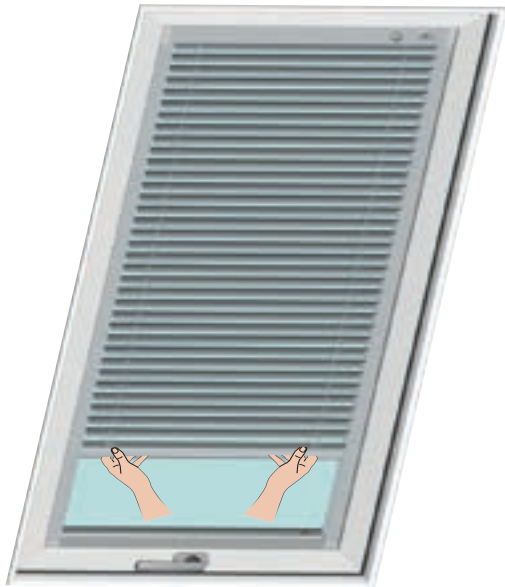

1

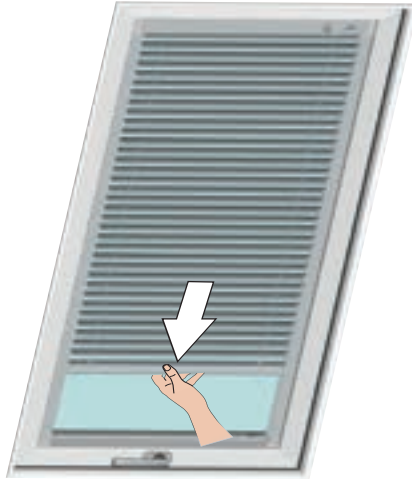

2

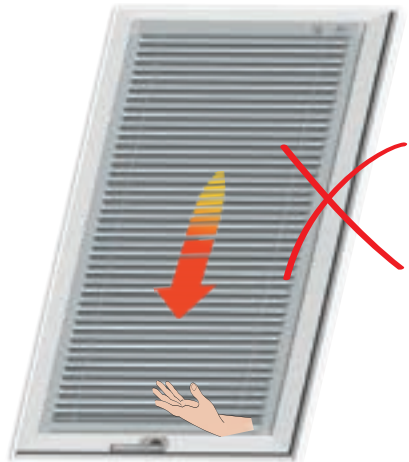

3

3

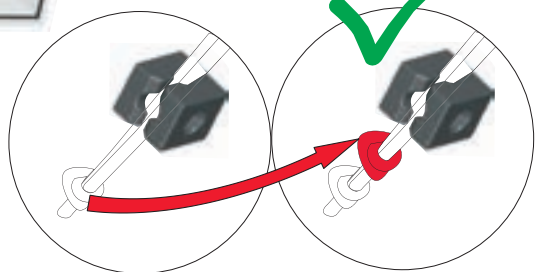
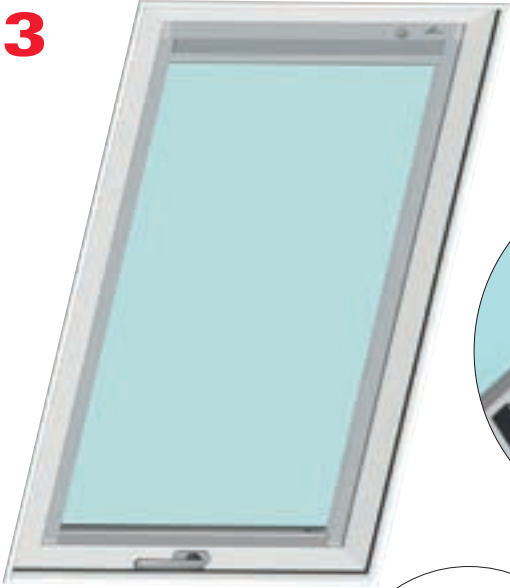

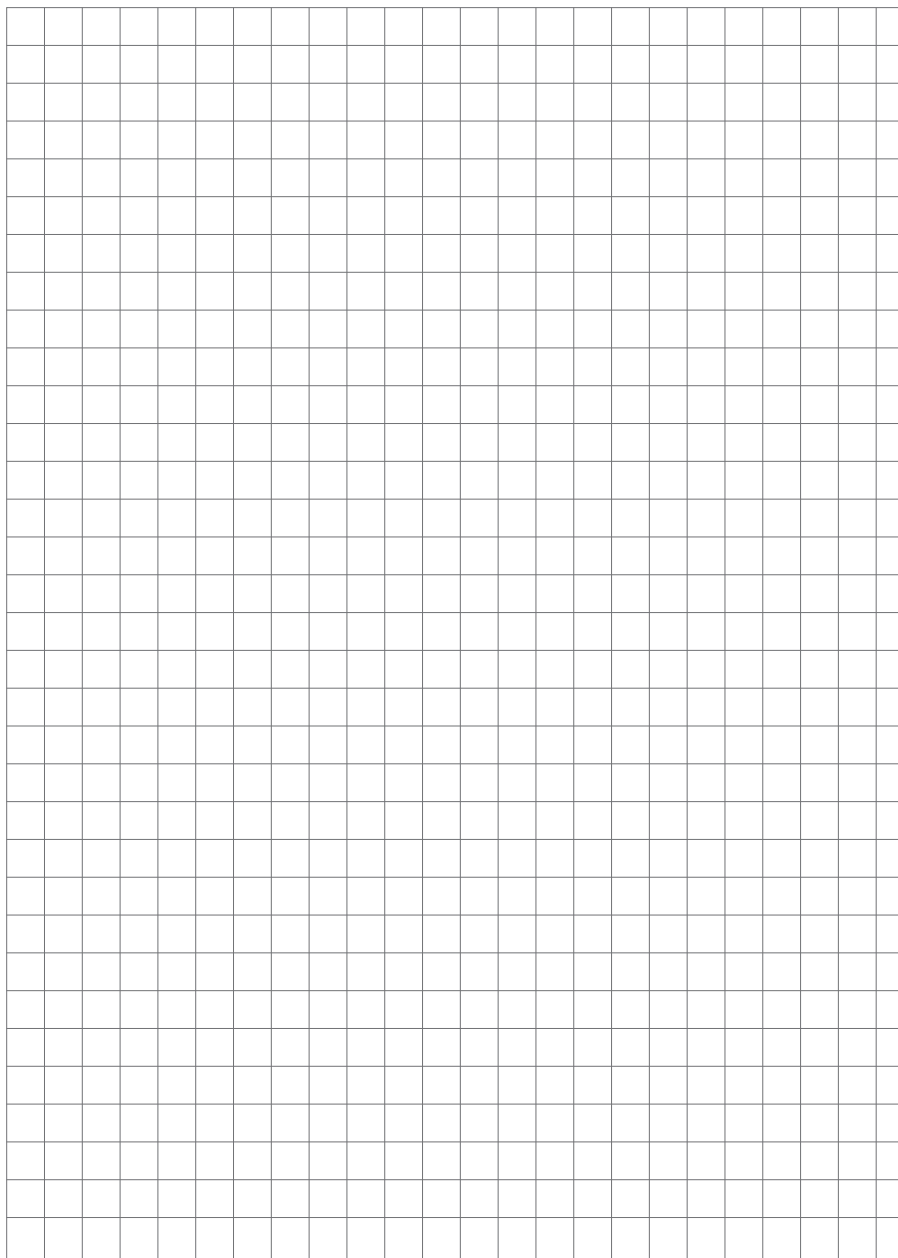

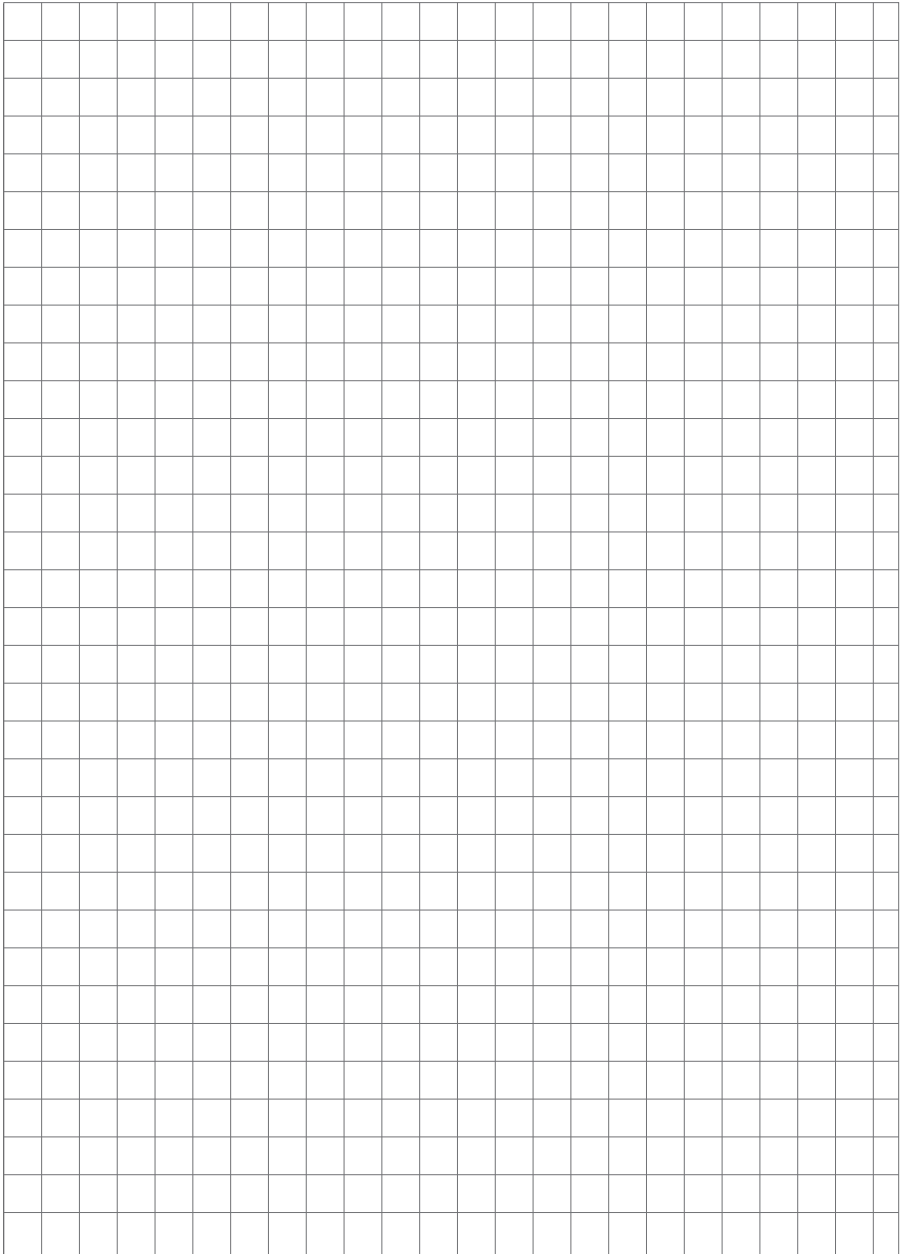



The roof window.



www.roto-contacts.com



www.roto-extra.com

EN GUARANTEE - Manufacturer's guarantee for the following countries.

DE GARANTIE - Herstellergarantie für die folgenden Länder.

PL GWARANCJA - Gwarancja producenta dla następujących krajów.

NL - GARANTIE - Garantie van de fabrikant voor de volgende landen.

FR - GARANTIE - Garantie du fabricant pour les pays suivants.

IT - GARANZIA - Garanzia del produttore per i seguenti paesi.

CZ - ZÁRUKA - Záruka výrobce pro následující země.

SK - ZÁRUKA - Záruka výrobcu pre nasledujúce krajiny.

HU - GARANCIA - Gyártói garancia a következő országokban.

DE / AT / CH / FR / NL / BE / LUX / LIE / IT / CZ / SK / PL / HU

For other countries please contact your distributor or contract partner.



www.roto-frank.com/dst/warranty

Roto Frank DST Vertriebs-GmbH
Wilhelm-Frank-Straße 38-40
97980 Bad Mergentheim
Deutschland

